

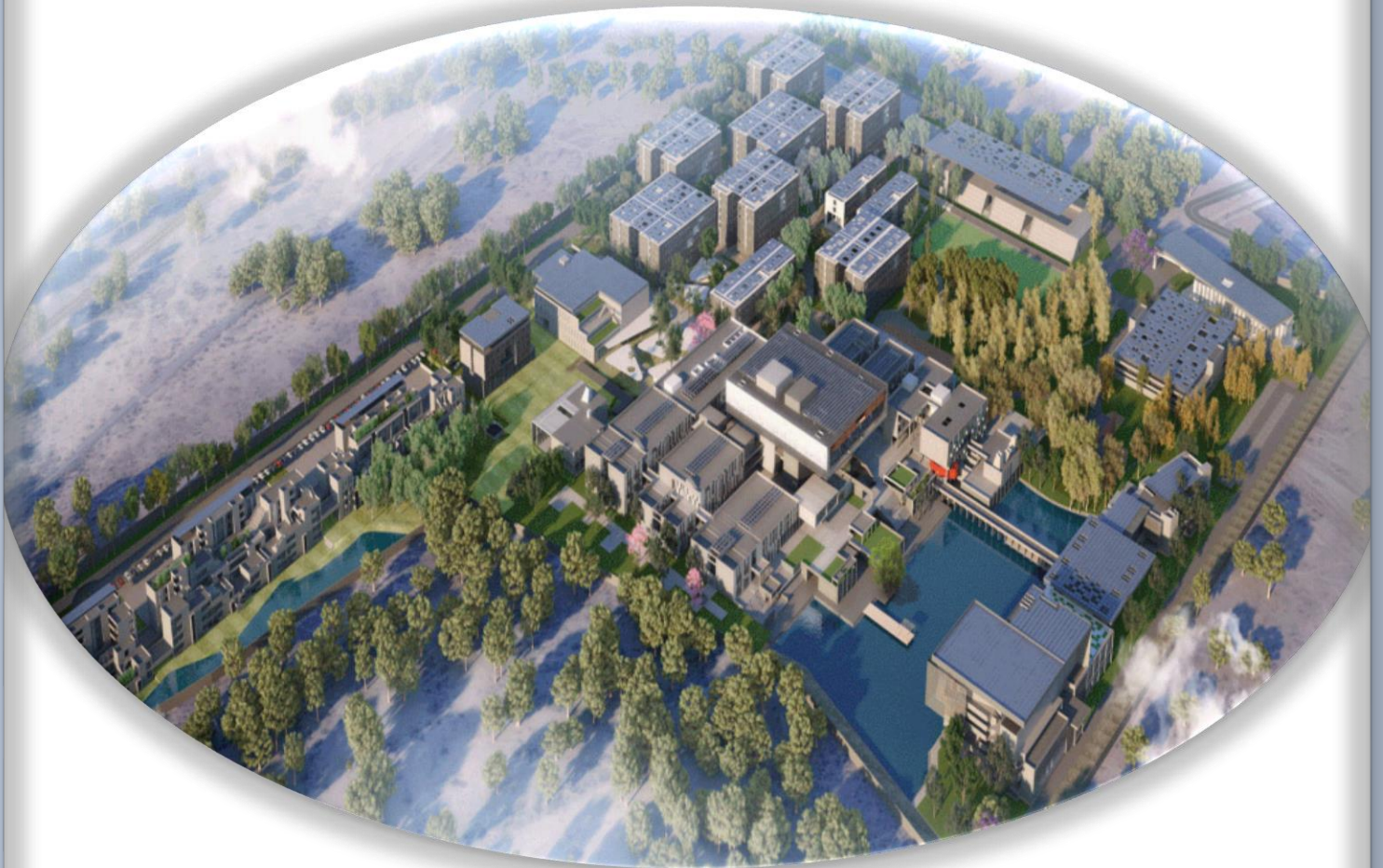

# **Maharashtra National Law University, Nagpur**

**(Established by Maharashtra Act No. VI of 2014)**



## **About the University**

Maharashtra National Law University, Nagpur (MNLU, Nagpur) was established by the Government of Maharashtra by way of enactment known as the Maharashtra National Law University Act (Maharashtra Act No. VI of 2014). Hon'ble Shri Justice Bhushan R. Gavai, Judge, Supreme Court of India, is the Chancellor of the University. It is a residential University engaged in teaching and promoting research in law and allied disciplines. The University is making all possible efforts to bring up state-of-the-art facilities. The University has a competent team of faculty and staff, who are qualified, experienced, committed, and full of zeal to create an institution of excellence in legal education in the country. The University has been recognised by the University Grants Commission (UGC), the University received necessary affiliation from the Bar Council of India (BCI), and it is also a member of Association of Indian Universities (AIU). The objectives of the University are manifold: to advance and disseminate learning and knowledge of law and legal processes and their role in national development; to develop sense of responsibility within the students and research scholars; to serve society in the field of law by developing skills in regard to advocacy, legal services, legislation, law reforms and the likes; to organize lectures, seminars, symposia, conferences and capacity building programmes; to promote legal knowledge and to make law and legal processes efficient instruments of social justice and development; to promote traditional, cultural, legal and ethical values with a view to promote and foster the rule of law and the objectives enshrined in the Constitution of India; and to liaison with institutions of higher learning and research in India and abroad.



**Prof. (Dr.) Vijender Kumar**  
Vice-Chancellor



**Shri Vivek B. Gavhane**  
Registrar

The University has established thirty-six centres for advanced legal studies and research to address the socio-legal issues and challenges, and to conduct cutting-edge research on thriving issues of law, social science, humanities, and management. Further, Ministry of Commerce and Industry, Department of Promotion of Industry and Internal Trade, Government of India has set up an Intellectual Property Rights (IPR) Chair at the University to encourage the study and research on Intellectual Property Rights as well as to promote outreach programmes on IPR in the region. The University has inked Memorandum of Understanding (MoU) with prominent law universities of the country for the purpose of academic collaboration to facilitate student and faculty exchange programme between the universities. Furthermore, the University has initiated a process of academic collaborations with top foreign universities of knowledge excellence and soon MoUs would be signed to take these collaborations further. In addition to this, active efforts are being made to develop joint training and research programmes that will be pursued in a collaborative spirit. The University has taken various steps towards welfare of the students by providing in campus Health and Wellness Centre with male and female doctor(s), career counsellor, psychologists, and personality development trainers. The students are expected to be sensitive towards the surroundings in their behaviour, attire, and manners. University strictly prohibits actions such as ragging, sexual harassment, etc., and views these actions as serious issues for disciplinary proceedings.



Academic Block



## **Infrastructure of the University**

The campus of the University is an outcome of a national-level 'Limited Architectural Design Competition' held in 2017. The fully residential campus on 60 acres of land provided by the Government of Maharashtra at Waranga, Nagpur, is being constructed in three phases and will eventually accommodate 3,500 students and faculty. The campus of the University is located at 19 kms from Dr. BR Ambedkar Nagpur Airport; 26 kms from the Nagpur Jn Railway Station; 26 kms from Nagpur Bus Stand (Ganeshpeth); and 17 kms from nearest Metro Station (Khapri). The Phase-I construction, consisting of academic buildings, hostels, amenities centre, administrative wing residential quarters, etc., will be completed by October 2024. The academic building, with an area of 11,000 square meters, consists of four blocks: three on the ground having 42 lecture theatres, two studios for distance and virtual education, and one block at lower ground level having two 200-seater conference halls and two 100-seater Seminar halls. The Academic building is flanked by a man-made lake of an approximate five-acre area on the North, a Terrace landscape on the East and a library and moot court on the West. The Academic building also hosts a 300-seating capacity amphitheatre with a lake as a backdrop and is meant to be used for interactive programs. Presently, there are in total 700 plus senior students housed at the Halls of Residence (Girls and Boys) on campus. Further, due to the shortage of hostel facilities (awaiting sufficient financial assistance from the Government of Maharashtra) for accommodating all the students as per the intake capacity in each of the courses, First-Year students of each of the courses will be accommodated at the off-campus hostel premises taken on rent by the University.



## University Library

The proposed Library is designed to provide archives, e-library, braille section, loud reading, group reading, carrel desks, isolated sections for mooters, isolated sections for Ph.D. scholars, AV studios, and many more. Metaphorically designed as the “Tree of Knowledge”. It will also host the Moot Court hall with a seating capacity of 200, along with the teachers’ lounge and Student Bar Council office. This building also connects the Administrative building to the Academic building via a foot-over bridge and forms the Academic-Admin-Library complex.



The University has developed its existing library resources on a need and requirement basis. It has received donations from various legal luminaries and institutions for the development of the Library. The University has subscribed to sixteen (16) Online Databases including HeinOnline, Westlaw, LexisNexis, SCC Online, Taxmann, Kluwer Arbitration, Kluwer Competition Law, JSTOR, Manupatra, LegitQuest, AIR Online, EBC Reader, EPW, Live Law, Corporate Law Advisor (CLA) besides sizeable number of eBooks and titles/volume of books (hard copies). Further, the existing library is equipped with hard copies of AIR from 1961 till date, Supreme Court Cases from 1969 till date, complete set of the Journal of Indian Law Institute from 1960 till date, Annual Survey of Indian Law from 1965 till date, and Taxation Reports from 1956 till date.





## **University Activities**

In addition to regular classes, the students are encouraged to participate in moot court competitions, seminars, webinars, conferences, workshops, debates, etc. All Saturdays are earmarked for value addition lectures, interactive sessions, and panel discussions by domain experts from different areas of law, social sciences, humanities, and management. Such interactions add a well-rounded perspective to the students' learning about law and allied subjects. The students are provided an opportunity to participate in the administrative activities of the University through their duly elected Student Bar Council of the University, elected by the representatives of various student committees such as the Hostel and Hospitality Committee; Academic Committee; Quiz, Debating and Literary Committee; Cultural Committee; Sports Committee; Internship Coordination Committee; Information Technology Committee; Moot Court Committee; Legal Aid Committee; Gender Sensitisation Committee; and Library Committee, that help in conduct and execution of routine, academic, and non-academic activities of the students. Such activities develop a sense of accountability, responsibility, and organisational skills among the students, which leads to honing their leadership qualities and developing a teamwork culture.

The University promotes various co-curricular and extracurricular activities for the students. The University also organises various internal competitions and academic activities such as Client Counselling Competitions, Meditation Competition, Internal Moot-Court Competitions, Parliamentary debates, Alternative Dispute Resolution etc., to help the students acquire lawyering skills and imbibe professional ethics. The University also implemented various policies in view of its student-centric approach for the welfare of the students, such as the Remedial Classes Policy, Teaching Assistantship Policy, Menstrual Leave for Students Policy, and Standard Operating Procedure (SOP) for Apprenticeship. The University also has its Academic Code of Conduct for the Students to ensure disciplined behaviour of the students on and off the campus of the University.

## **Academic Activities of the University**

The University has successfully organised a series of lectures of eminent experts of different domain of law and allied subjects; in addition, two endowment memorial lecture series were instituted at the University in memory of the late Shri G.L. Sanghi, Former Senior Advocate, Supreme Court of India and late Shri Justice S.M. Daud, Former Judge, Bombay High Court respectively.

The University has organised various Faculty Development Programmes. It has also signed an MoU with Commissioner of Police, Nagpur City, for the purpose of Research Collaboration to study the increasing trend of violent crimes and suggest measures for its prevention after scientific understanding of causational factors. The University was keen on keeping to its commitment towards research along with the academic activities. The University has organised various activities under aegis of DPIIT-IPR Chair established by Department for Promotion of Industry and Internal Trade.

In furtherance to uphold academic activities, the University is successfully running its peer-reviewed flagship Bi-annual journal *viz.*, Contemporary Law Review (CLR); Contemporary Law and Policy Review (CLPR); and E-Journal of IPR Chair.

Presently, the University offers B.A.LL.B.(Hons.) Five-Year Integrated Degree Course, B.A.LL.B.(Honours in Adjudication and Justicing) Five-Year Integrated Degree Course, B.B.A.LL.B.(Hons.) Five-Year Integrated Degree Course, One-Year LL.M. (Postgraduate) Degree Course, Doctor of Philosophy (Ph.D.) Programme besides offering One-Year LL.M. (Postgraduate)

Degree Course for Executives, Two-Year LL.M. (Postgraduate) Degree Course on Administration of Justice for Professional, and various Diploma Courses. The University is committed to achieve excellence in the field of legal and justice education by promoting innovative research in the fields of law, social sciences, and humanities. The doctoral programme is an integrated programme wherein scholars from different streams are eligible for admission, provided their research interfaces with public policy and law.

The University follows a semester system with five working days in a week, a minimum of 90 working days in a semester, and 180 days in an academic year in addition to the days of examinations. The University introduced a Choice-Based Credit System (CBCS) for the Undergraduate Degree courses. The students are required to earn a total of 220 credits spread out through the course of five years; however, the students shall be allowed to earn extra credits from the courses offered by external experts from time to time. The academic performance of the students on a continuation basis is evaluated on a 10 (ten) point scale with corresponding grade values.

## **Undergraduate Degree Programmes**

### **B.A.LL.B.(Honours) Five-Year Integrated Degree Course**

The academic curriculum of the University is designed as per the University Grants Commission's (UGC) Curriculum Development Committee Report (CDCR), wherein the recommendations of the CDCR and the Bar Council of India (BCI) have been considered as the basic parameters to bring it in consonance with trends of globalization, pluralism, and social integration. Clinical legal education and moot court exercises are integral components of the university's academic curriculum, through which students understand how to appreciate practical socio-economic and legal issues and help society at large. The course curriculum promotes an interdisciplinary approach with integration between law and social sciences or humanities.

### **Eligibility for Admission**

The eligibility is as per the Common Law Admission Test conducted by the Executive Committee of the Consortium of National Law Universities; for details, visit the Consortium's Website.

### **Intake and Reservation: Total = 120 Seats**

Category	Percentage	No of Seats
Scheduled Castes of Maharashtra	13	16
Scheduled Tribes of Maharashtra	07	08
De-notified Tribes (A) of Maharashtra	03	04
Nomadic Tribes (B) of Maharashtra	2.5	03
Nomadic Tribes (C) of Maharashtra	3.5	04
Nomadic Tribes (D) of Maharashtra	02	02
Special Backward Class of Maharashtra	02	02
Other Backward Classes (OBC) of Maharashtra	19	23
Economically Weaker Sections (EWS) of Maharashtra	10	12
Socially and Economically Backward Classes (SEBC)	10	12
Unreserved Seats	--	34
<b>Total Seats</b>		<b>120</b>

**Note 1:** Five percent (5%) horizontal reservation towards Specially Abled Person (SAP) - (with benchmark disabilities).

**Note 2:** Thirty percent (30%) horizontal reservation for Women candidates.

**Note 3:** Five percent (5%) horizontal reservation to the wards of Servicemen/Ex-Servicemen of Maharashtra.

## **B.A.LL.B.(Honours in Adjudication and Justicing) Five-Year Integrated Degree Course**

In furtherance of the vision of the founder Chancellor of the University, Hon'ble Shri Justice S. A. Bobde, the Former Chief Justice of India, to enhance justice education, the University is offering B.A.LL.B.(Honours in Adjudication and Justicing) since 2020; a first-of-its-kind course in the country. The course aims to impart intensive and exhaustive practical training and equip students for entry-level Judiciary. The curriculum focuses on pluralism, social integration, and the socio-cultural structure of the State. The course is designed to produce well-rounded judicial officers of the very best capabilities, ready to decide cases of any kind anywhere, and who would be given practical training in the art of judging actual cases being heard by a court. It is a Five-Year Integrated Degree Course of Ten Semesters; the last Semester is reserved for Judicial Apprenticeship. Regular Internships till Semester-IX and Six months of Judicial Apprenticeship in Semester-X, make it a fully practical course.

### **Eligibility for Admission**

The candidates fulfilling the following criteria are eligible to apply:

- Candidates must have appeared in the CLAT of the academic year of admission;
- Candidates must have completed Higher Secondary Education, i.e., 10+2 or an equivalent examination with forty-five percent (45%) or its equivalent grade in case of candidates belonging to Unreserved/OBC/SBC/EWS categories and forty percent (40%) marks or its equivalent grade in case of candidates belonging to SC/ST/NT (A,B,C, & D)/PwD Categories;
- Candidate should be an Indian Citizen; and
- The age of the candidate shall not be above 20 (twenty) years on the date of application.

### **Admission Process:**

The University takes CLAT Score only for the purpose of shortlisting the candidates. Interested are required to apply separately and the following process shall be followed:

- a) CLAT Score based Shortlisting;
- b) Group Discussion;
- c) Psychometric Test; and
- d) Personal Interview.

### **Intake and Reservation: Total = 60 Seats**

Category	Percentage	No of Seats
Scheduled Castes of Maharashtra	13	08
Scheduled Tribes of Maharashtra	07	04
De-notified Tribes (A) of Maharashtra	03	02
Nomadic Tribes (B) of Maharashtra	2.5	02
Nomadic Tribes (C) of Maharashtra	3.5	02
Nomadic Tribes (D) of Maharashtra	02	01
Special Backward Class of Maharashtra	02	01
Other Backward Classes (OBC) of Maharashtra	19	11
Economically Weaker Sections (EWS) of Maharashtra	10	06
Socially and Economically Backward Classes (SEBC)	10	06
Unreserved Seats	--	17
<b>Total Seats</b>		<b>60</b>

**Note 1:** Five percent (5%) horizontal reservation towards Specially Abled Person (SAP) - (with benchmark disabilities).

**Note 2:** Thirty percent (30%) horizontal reservation for Women candidates.

**Note 3:** Five percent (5%) horizontal reservation to the wards of Servicemen/Ex-Servicemen of Maharashtra.

## **B.B.A.LL.B.(Honours) Five-Year Integrated Degree Course**

This course aims to create talented and proficient law graduates with potential lawyering-cum-managerial skills to meet the needs of the modern legal system in national and global sustainable development. It enables the young aspirants to acquire legal education in an insightful manner to cope with the contemporary expansion in the corporate world with strong basics, comprehensive legal acquaintance, and a set of lawyering skills to plead for justice and legal causes. Along with the law courses, the students will also be groomed in management subjects such as Principles of Management, Financial Management, Marketing, Accounting, and Human Resource Management to fulfil professional industry requirements. The course is intended to improve the independent critical thinking of legal aspirants with research competencies and to ensure that the students are groomed to be capable of promoting the role of lawyers in the Globalizing World.

### **Eligibility for Admission**

The eligibility is as per the Common Law Admission Test conducted by the Executive Committee of the Consortium of National Law Universities; for details, visit the Consortium's website.

### **Intake and Reservation: Total = 60 Seats**

Category	Percentage	No of Seats
Scheduled Castes of Maharashtra	13	8
Scheduled Tribes of Maharashtra	07	04
De-notified Tribes (A) of Maharashtra	03	02
Nomadic Tribes (B) of Maharashtra	2.5	02
Nomadic Tribes (C) of Maharashtra	3.5	02
Nomadic Tribes (D) of Maharashtra	02	01
Special Backward Class of Maharashtra	02	01
Other Backward Classes (OBC) of Maharashtra	19	11
Economically Weaker Sections (EWS) of Maharashtra	10	06
Socially and Economically Backward Classes (SEBC)	10	06
Unreserved Seats	--	17
<b>Total Seats</b>		<b>60</b>

**Note 1:** Five percent (5%) horizontal reservation towards Specially Abled Person (SAP) - (with benchmark disabilities).

**Note 2:** Thirty percent (30%) horizontal reservation for Women candidates.

**Note 3:** Five percent (5%) horizontal reservation to the wards of Servicemen/Ex-Servicemen of Maharashtra.

## **Postgraduate Degree Programme**

### **One-Year LL.M. (Postgraduate) Degree Course**

The University offers One-Year Postgraduate Degree Course (LL.M.). The eligible candidates shall be admitted to the course, and thereafter, students shall be asked to choose their specialisation. Presently, the University offers the following specialisations, viz., (1) Corporate and Commercial Laws, (2) Intellectual Property Laws, (3) Constitutional Law; (4) Personal Laws; and (5) Criminal Law and Forensic Science. Further, fifteen (15) Seats are earmarked for LL.M. (General).

### **Eligibility for Admission**

The eligibility is as per the Common Law Admission Test conducted by the Executive Committee of the Consortium of National Law Universities; for details, visit the Consortium's website.



**Intake and Reservation: Total = 60 Seats**

Category	Percentage	No of Seats
Scheduled Castes of Maharashtra	13	8
Scheduled Tribes of Maharashtra	07	04
De-notified Tribes (A) of Maharashtra	03	02
Nomadic Tribes (B) of Maharashtra	2.5	02
Nomadic Tribes (C) of Maharashtra	3.5	02
Nomadic Tribes (D) of Maharashtra	02	01
Special Backward Class of Maharashtra	02	01
Other Backward Classes (OBC) of Maharashtra	19	11
Economically Weaker Sections (EWS) of Maharashtra	10	06
Socially and Economically Backward Classes (SEBC)	10	06
Unreserved Seats	--	17
<b>Total Seats</b>		<b>60</b>

**Note 1:** Five percent (5%) horizontal reservation towards Specially Abled Person (SAP) - (with benchmark disabilities).

**Note 2:** Thirty percent (30%) horizontal reservation for Women candidates.

**Note 3:** Five percent (5%) horizontal reservation to the wards of Servicemen/Ex-Servicemen of Maharashtra.

**Note:**

1. The fee structure of the above-mentioned undergraduate and postgraduate degree courses will be published on the University website; and
2. The University reserves the right to amend the intake and duration of courses from time to time for both undergraduate and postgraduate courses. For Course Curriculum, Fee Structure, Examination Regulations and other details of the University, please visit the University website @ [www.nlunagpur.ac.in](http://www.nlunagpur.ac.in)

**For Further Details, Contact:****The Registrar**

Maharashtra National Law University, Nagpur  
 Waranga, Butibori, Nagpur – 441108 Maharashtra, INDIA Ph. No.: +91-712-2812605  
 E-mail: [registrar@nlunagpur.ac.in](mailto:registrar@nlunagpur.ac.in), [admission@nlunagpur.ac.in](mailto:admission@nlunagpur.ac.in)